



CY006 English

CYANHemato Hematology Analyzer

**Delivered with a FREE
starter kit for 600 tests!**



To all Healthcare Professionals,

Thank you for your interest. We appreciate it!

Cypress Diagnostics provides the tools and solutions that let clinical laboratories worldwide deliver clear and precise diagnostic results.

We manufacture the equipment needed for handling the samples, analyzers to perform the tests, reagents to carry out the tests and - increasingly often - the software platforms to report the results.

Cypress Diagnostics supplies clinical laboratories.

We are a quality-oriented company with ISO certification and CE-approved products. Our production facility is located in Hulshout, Belgium. Our products are preferred and appreciated by users in more than 100 countries worldwide. Cypress Diagnostics is a family-owned business, founded in 1995 in Leuven, Belgium.

We work exclusively with selected and trained distributors. We sell high-quality instruments and customer service is an integral part of our quality policy. All our products come with an aftersales and performance guarantee.

Please feel free to contact our local distributor for more information. Our latest inserts and catalogs are downloadable on www.diagnostics.be.

Test the difference!

Kind regards,

The Cypress Diagnostics Team

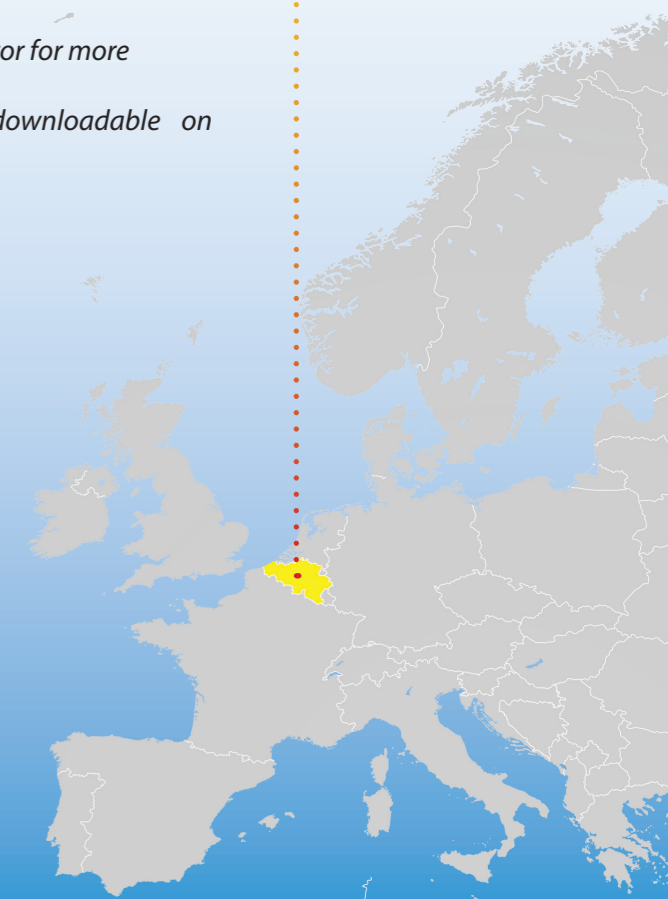

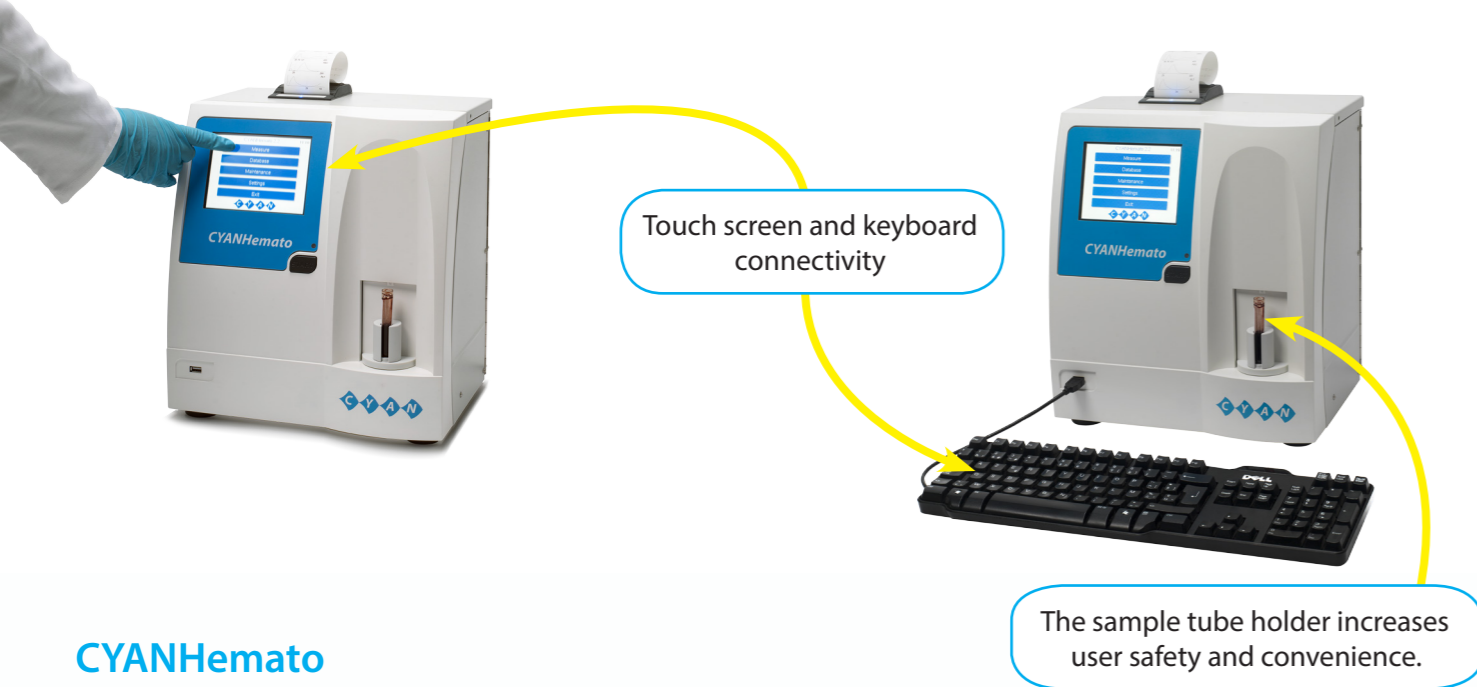

CYANHemato

The **CYANHemato** is a fully automated, 20-parameter, bench-top hematology cell counter. The analyzer can process 30 samples per hour in 3-part WBC differential mode.

Highlights:

- 20 hematology parameters
- 3-part WBC differential
- Only 25 µl whole blood sample needed
- Easy to use
- Color LCD touch screen
- USB connectivity
- Predilution mode
- Automatic daily maintenance
- Large memory
- Effective QC software

Code	Name	Packing	CE	T°	
				2 - 8 °C	15 - 30 °C
Reagents					
CY006-R01	Diluent	20 L	•		•
CY006-R02	Lyse	1 L	•		•
CY006-R03	Cleaner	1 L	•		•
Cleaners					
CY006-R04	Hypoclean	1 L	•		•
CY006-R05	Clenz	1 L	•		•
CY006-R06	Hypoclean CC 100ml	100 ml	•		•
Controls					
CY006-C01A	Control vial normal	1 x 2,5 ml	•	•	
CY006-C02A	Control vial low/normal/high	3 x 2,5 ml	•	•	

All reagents and cleaners have an open bottle stability of 120 days after opening. These are the only reagents that are calibrated for the **CYANHemato** (Closed system).

The hematology control values can be uploaded into the **CYANHemato** by USB. You can download these (INI) files from our website.

Technical Specifications

The analyzer determines the following 20 hematology parameters:

- WBC total white blood cell count
- LYM lymphocyte count
- MON monocyte count
- GRA granulocyte count
- LYM % lymphocyte percentage
- MON % monocyte percentage
- GRA % granulocyte percentage
- HGB hemoglobin
- RBC red blood cell count
- HCT hematocrit
- MCV mean corpuscular volume
- MCH mean corpuscular hemoglobin
- MCHC mean corpuscular hemoglobin concentration
- RDW red blood cell distribution width
- PLT platelet count
- PCT platelet percentage, thrombocrit
- MPV mean platelet volume
- PDW platelet distribution width
- P-LCC platelet large cell count
- P-LCR platelet large cell ratio

Sample volume:

- 25 µl of whole blood in normal mode
- 50 µl of whole blood in pre-diluted mode

Measurement:

- Aperture diameter 70 µm (RBC, PLT, WBC)
- Throughput 30 tests/hour

Reagent requirement:

- Diluent - 20 liter (code: CY006-R01)
- Lyse - 1 liter (code: CY006-R02)
- Cleaner - 1 liter (code: CY006-R03)

Sampling:

- Open tube system
- Automatic sample rotor
- Multiple sample profiles

Cleaning procedure of the aperture:

- High-voltage burn
- High-pressure back-flush
- Chemical cleaning

Calibration:

- Automatic calibration based on ≥ 1 measurement(s)
- Manual calibration using theoretical factors

User interface:

- Easy-to-use
- Full-LCD touch screen
- External keyboard (in option, via USB)
- Languages: English, French, Spanish, Portuguese, and Russian

Memory:

- 10.000 results, with RBC, PLT, and WBC 3-part histogram

Printer:

- Built-in thermal printer
- Full report with histograms
- Interface via USB for HP printers

Power:

- 110/220 V - 50/60 Hz
- Advised: Electronic Stabilizer (> 1 kW Power potential) No-Break Module (UPS - Uninterruptible Power Supply)

Operation temperature:

- 15 - 30 °C
- In covered and dry places
- Stable surface (no vibrations)

Weight and dimensions:

- 32 x 26 x 36,5 cm (L x W x H)
- 12 kg

Order code:

- CY006: [CYANHemato](#)

Contact: e-mail: cypress@diagnostics.be
tel: + 32 (0)15 67 67 68

Headquarters: Cypress Diagnostics
Langdorpsesteenweg 160
3201 Langdorp
Belgium

Factory: Nijverheidsstraat 8
2235 Hulshout
Belgium

URL: www.diagnostics.be

Your Distributor